

LANDSCAPE PLAN:

See Sheet L2 for Planting Details, Notes, and Requirements

Calyx Design Group, LLC
Landscape Architecture-Sustainable Design-Planning
370 Selby Avenue | Suite 303 | Saint Paul, MN 55102

telephone: 001.357.3730
internet: www.calyxdesigngroup.com
e-mail: ben@calyxdesigngroup.com

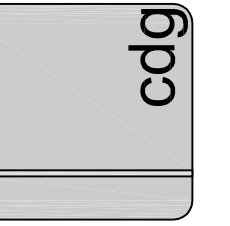

Print Name: Benjamin D. Hartberg, PLA

Signature: _____
Date: _____ License No. 48084

PRELIMINARY LANDSCAPE PLAN
FOR
SOUTH SHORE DEVELOPMENT, INC.
16972 BRANDT/JEN FARM DR., LAKEVILLE, MN 55044

DRAWN BY
BH

DATE
11/9/15

REVISIONS

CAD FILE
22241-65L

PROJECT NO.	22241-65
-------------	----------

1

Qty.	Key	Scientific Name	Common Name	Size	Root	Notes
7	A	Quercus bicolor	Swamp White Oak	2.5" Cal.	B&B	
9	B	Acer rubrum 'October Glory'	Red Maple	2.5" Cal.	B&B	
8	C	Ulmus X 'Patriot'	Patriot Elm	2.5" Cal.	B&B	
6	D	Tilia cordata	Littleleaf Linden	2.5" Cal	B&B	
8	E	Ostrya virginiana	Ironwood	2.5" Cal	B&B	

CONIFEROUS TREES:						
Qty.	Key	Scientific Name	Common Name	Size	Root	Notes
8	F	<i>Picea glauca</i> var. <i>densata</i>	Black Hills Spruce	6' Hgt.	B&B	Full Form
13	G	<i>Pinus resinosa</i>	Norway Pine	6' Hgt.	B&B	Full Form

Qty.	Key	Scientific Name	Common Name	Size	Root	Notes
8	F	<i>Picea glauca</i> var. <i>densata</i>	Black Hills Spruce	6' Hgt.	B&B	Full Form
13	G	<i>Pinus resinosa</i>	Norway Pine	6' Hgt.	B&B	Full Form

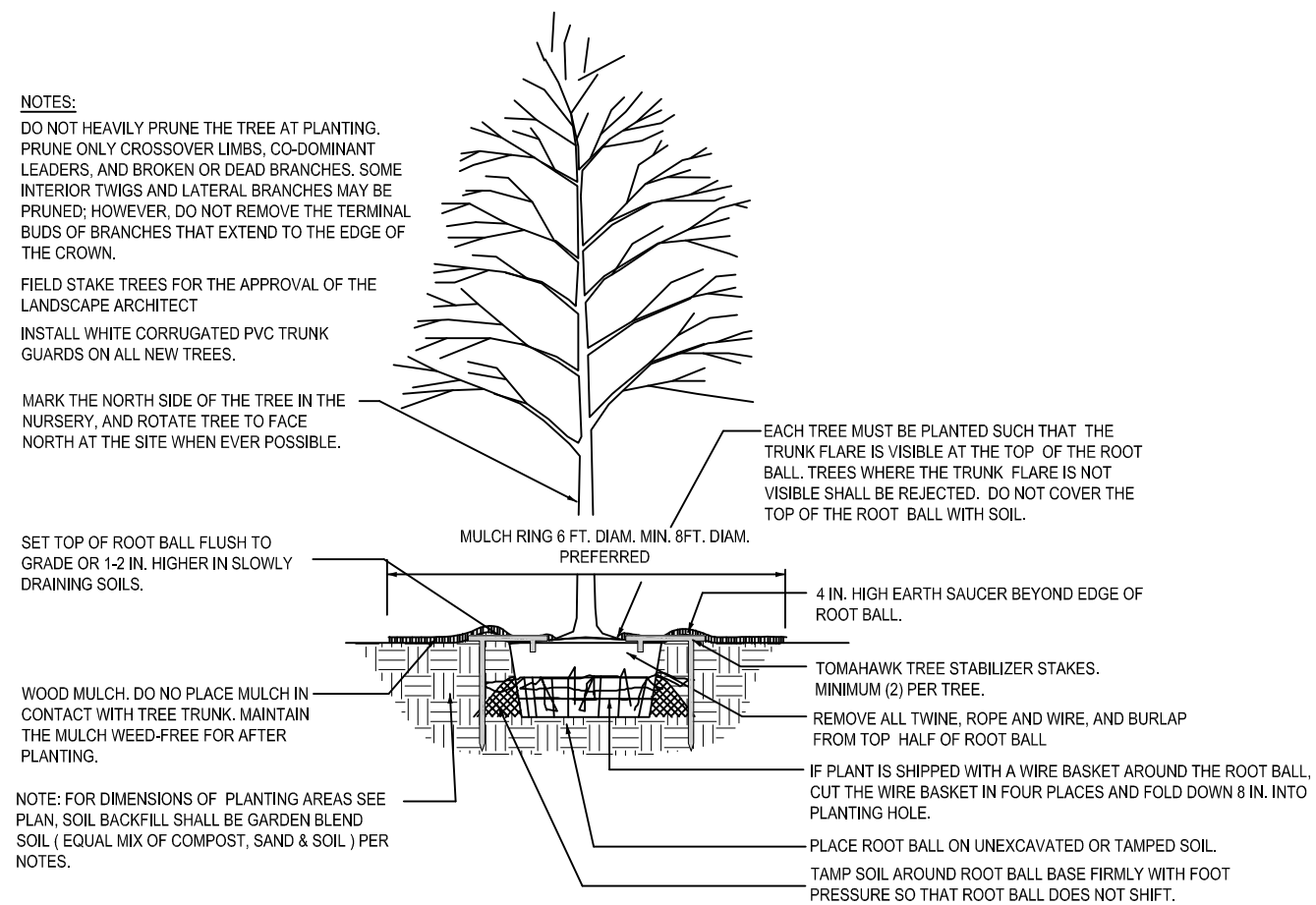

NOT TO SCALE

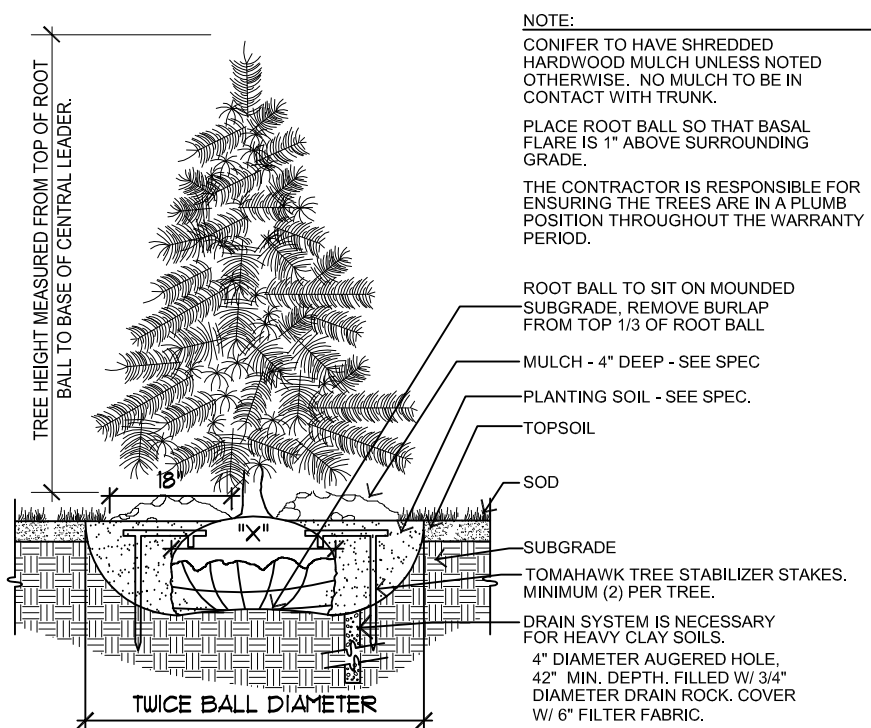

NOT TO SCALE

1. Tree saucer mulch to be four inches (4") depth natural single-shred hardwood mulch for trees outside of a plant bed. Install per tree planting detail.
2. Refer to civil plan sheets for grading, drainage, site dimensions, survey, tree removal, proposed utilities & erosion control.
3. All plant material shall comply with the latest edition of the American Standard for Nursery, American Association of Nurserymen. Unless noted otherwise, deciduous shrubs shall have at least 5 canes at the specified shrub height. Plant material shall be delivered as specified.
4. Plan takes precedence over plant schedule if discrepancies in quantities exist.
5. All proposed plants shall be located and staked as shown.
6. Adjustment in location of proposed plant material may be needed in field. Should an adjustment be required, the client will provide field approval. Significant changes may require city review and approval.
7. The project landscape contractor shall be held responsible for watering and properly handling all plant materials brought on the site both before and after installation. Schedule plant deliveries to coincide with expected installation time within 36 hours.
8. All plant materials shall be fertilized upon installation as specified.
9. The landscape contractor shall provide the owner with a watering schedule appropriate to the project site conditions and to plant material growth requirements.
10. If the landscape contractor is concerned or perceives any deficiencies in the plant selections, soil conditions, drainage or any other site condition that might negatively affect plant establishment, survival or guarantee, they must bring these deficiencies to the attention of the landscape architect & client prior to bid submission. Plant bed drainage concerns during plant installation shall be brought to the attention of the Owner and General Contractor immediately.
11. Contractor shall establish to his/ her satisfaction that soil and compaction conditions are adequate to allow for proper drainage at and around the building site.
12. Contractor is responsible for ongoing maintenance of all newly installed material until time of owner acceptance. Any acts of vandalism or damage which may occur prior to owner acceptance shall be the responsibility of the contractor. Contractor shall provide the owner with a maintenance program including, but not limited to, pruning, fertilization and disease/pest control.
13. The contractor shall guarantee newly planted material through one calendar year from the date of written owner acceptance. Plants that exhibit more than 10% die-back damage shall be replaced at no additional cost to the owner. The contractor shall also provide adequate tree wrap and deer/rodent protection measures for the plantings during the warranty period.
14. This layout plan constitutes our understanding of the landscape requirements listed in the ordinance. Changes and modifications may be requested by the city based on applicant information, public input, council decisions, etc.
15. The landscape contractor shall be responsible for obtaining any permits and coordinating inspections as required throughout the work process.
16. Plant size & species substitutions must be approved in writing prior to acceptance in the field.

17. The landscape contractor shall furnish an Irrigation Layout Plan for head-to-head coverage of all tree, turf and shrub planting areas. Use commercial-grade irrigation equipment and provide product cut-sheets and (4) copies of the proposed layout plan to the landscape architect for review and approval. Coordinate irrigation connection point, controller, back-flow and valve locations with the architect & general contractor. Irrigation system shall be zoned such that plants over building structure are separate.

18. All edger shall be professional grade black steel edger, 1/8" Thick, 12' straight lengths. Anchor every 18" on-center (minimum). Submit sample.

19. Landscape Contractor is responsible for coordination with the General Contractor, to protect the new improvements on and off-site during landscape work activities. Report any damage to the General Contractor immediately.

20. Unless otherwise noted/indicated, plant beds shall receive 4" depth single-shred hardwood mulch over fabric weed mat, per detail. Submit mulch sample for Owner approval. Do not install weed mat under perennials, with the exception of ornamental grasses.

21. Rock mulch for foundation planting areas shall be 3/4-1 dia. inch limestone rock mulch. Install per detail. Submit mulch samples for approval.

22. All planting, seeding, and sodded areas shall be prepared prior to installation activities with a harley power box rake or equal to provide a firm planting bed free of stones, sticks, construction debris, etc.

23. Turf installation activity shall conform to all rules and regulations as established in the MnDOT Seeding Manual, 2014 edition, for turf bed preparation, installation, maintenance, and warranty.

24. The Landscape Contractor shall furnish samples of all landscape materials for approval prior to installation.

25. The Landscape Contractor shall clear and grub the underbrush from within the work limits to remove dead branches, leaves, trash, weeds and foreign materials. Remove trees where noted on the plan, including the stump to 30" below grade.

26. The landscape contractor shall contact Gopher State One Call no less than 48 hours before digging for field utility locations.

27. The landscape contractor shall be responsible for the removal of erosion control measures once vegetation has been established to the satisfaction of the municipal staff. This includes silt curtain fencing and sediment logs placed in the landscape.

26. The landscape contractor shall be responsible for visiting the site to become familiar with the conditions prior to bidding and installation. Coordinate with the general contractors on matters such as fine grading, landscaped area conditions, staging areas, irrigation connection to building, etc.

29. See Site and Civil plans for additional information regarding the project.

30. All sub-cut areas of the site that are designated on the site plan as open space for landscape shall have no less than 6" of imported, pulverized topsoil. Slope away from building.

31. Landscape contractor must prove the open sub-grade of all planting areas after their excavation is capable of infiltrating a minimum requirement of 1/4-inch of water per hour prior to installation of plant materials, topsoil, irrigation, weed mat, and mulch. Planting areas not capable of meeting this requirement shall have 4" diameter X 48" depth holes augured every 36" on-center and filled with MnDOT Free-Draining Coarse Filter Aggregate. Re-test sub-grade percolation for compliance to infiltration minimum requirement.

32. Fencing (if noted) per Architect's Plans and Specifications.

33. Landscape contractor shall coordinate tree removal activities and ensure all trees designated for removal are gone before start of landscape installation. Grind stump to 30" below grade and back-fill with topsoil.

34. Landscape contractor shall include in their bid to remove any existing shrubs, sod, edger, fabric, and edger that interferes with new improvements shown in this package.

35. Retaining wall, stair design, & structural engineering by others. See civil plans for complete wall heights and grading requirements.

36. Native Seed Area: Prairie seeding contractor shall provide the Owner with a proposal for (2) additional years of prairie maintenance, in addition to the (1) year warranty. It shall be the Owner's option to continue maintenance of the native prairie areas. Maintain under warranty per MnDOT Seeding Manual, 2014 edition.

Calyx Design Group, LLC
Landscape Architecture-Sustainable Design-Planning
37370 Selby Avenue | Suite 303 | Saint Paul, MN 55102

telephone: 651.334.5498
internet: www.calyxdesigngroup.com
e-mail: ben@calyxdesigngroup.com

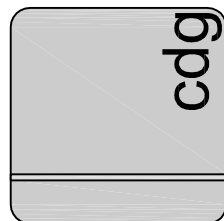

I hereby certify that this plan, specification,
 or report was prepared by me or under my
 direct supervision and that I am a duly
 Licensed Landscape Architect under the
 laws Of the State of Minnesota.

Print Name:	Benjamin D. Hartberg, PLA
Signature:	
Date:	License No. 48084

COBBLESTONE LAKE NORTH SHORE —
2ND ADDITION
APPLE VALLEY, MINNESOTA

**PRELIMINARY LANDSCAPE PLAN
FOR
SOUTH SHORE DEVELOPMENT, INC.**

16672 BRANDTJEN FARM DR., LAKEVILLE, MN 55044

DRAWN BY
BH

DATE
11/9/15

REVISIONS

CAD FILE
22241-65L

PROJECT NO.
22241-65

L2